

Appendix 1

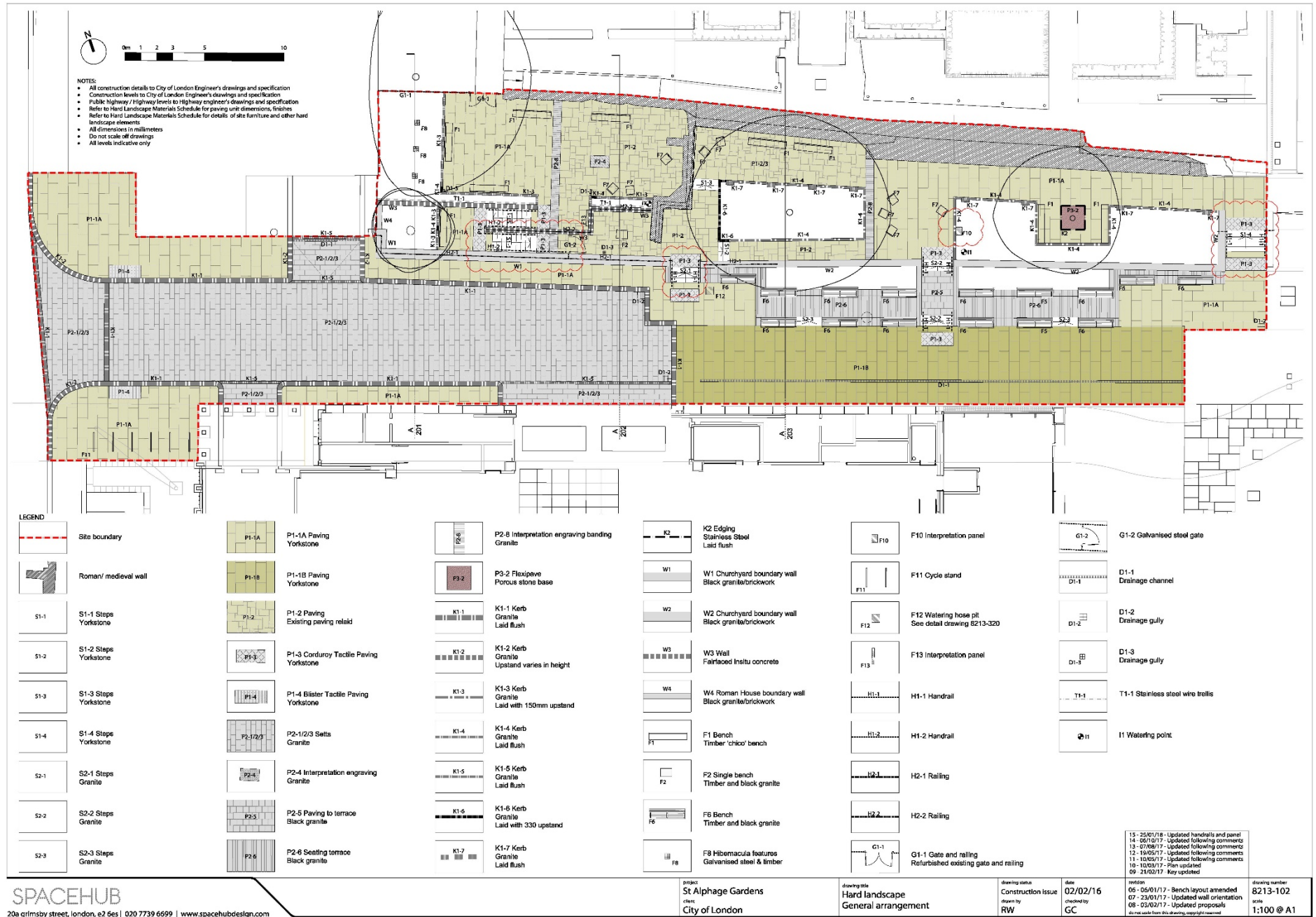

Appendix 2



St Alphege Gardens before



Use of the gardens increased significantly after it re-opened to public in summer 2019.

Appendix 2



Image courtesy of Spacehub



The project transformed this area into a fit-for-purpose, high quality landscape, capitalising on the wider network of green infrastructure being delivered through the development and providing an appropriate setting for the historic London Wall.

Image courtesy of Spacehub

Appendix 2



Text engraved into coping stones and paving as well as feature paving stone demarcate the likely footprint of the former Church of St Alphage.